

SPECIFICATION CONTROL DRAWING

THIS DRAWING CONTAINS INFORMATION PROPRIETARY TO RF INDUSTRIES, LTD. ANY UNAUTHORIZED USE OF THIS DRAWING IS EXPRESSLY PROHIBITED. ANY VIOLATION IS PUNISHABLE UNDER U.S. COPYRIGHT LAWS.

REV	DESCRIPTION	DWN	DATE	APPROVED
A	ENGINEERING RELEASE [DWG # 7142]	DB	4/11/91	R. SMITH
B1	CREATE SECTION DRAWING [DWG # 8108B1]	PB	5/24/93	J. BENZ
C	STANDARDIZE	KMM	11/17/94	R. RICE
D	CHG BODY ID, DIE OD, PIN OD, & CONTACT DIM / UPDATE DWG	CZS	4/20/98	R. RICE

ALL DIMENSIONS ARE REFERENCE ONLY

000000

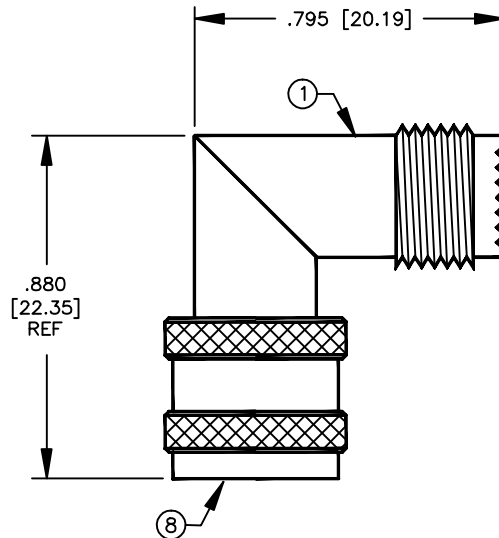

SPECIFICATIONS:

IMPEDANCE: 50 OHMS
 WORKING VOLTAGE: 335 VRMS @ SEA LEVEL
 FREQUENCY RANGE: 0-2.5 GHz

ITEM	DESCRIPTION	QTY	MATERIAL	FINISH
9	PRESS FIT WASHER	1	BRASS	NICKEL
8	SHELL	1	BRASS	NICKEL
7	RETAINING RING	1	BRASS	NONE
6	PRESS FIT WASHER	1	BRASS	NICKEL
5	DIELECTRIC	1	PTFE	NONE
4	DIELECTRIC	1	PTFE	NONE
3	CONTACT	1	BRASS	GOLD
2	PIN	1	BRASS	GOLD
1	BODY	1	BRASS	NICKEL

DIMENSIONS ARE IN INCHES AND [MILLIMETERS]

UNLESS OTHERWISE NOTED TOLERANCES ARE:

DECIMALS DIAMETER

DRAWN
C. ZUNIGA 4/20/98

CHECKED

ORJ DRAWN
--- 8/20/85

APPROVALS DATE

RFconnectors
 DIVISION OF RF INDUSTRIES, LTD.

7610 MIRAMAR RD
 SAN DIEGO, CA 92126
 (619)549-6340
 (619)549-6345 FAX

RFU-630

MINI UHF MALE TO MINI UHF FEMALE R/A

SIZE	CABLE GROUP	DWG NO.	REV
A	N/A	8108	D

SCALE: 2:1 CAD FILE 13ARC B SHEET 1 OF 1